

Tool Steel Cutting Dies are used for the cutting of plastics, paper, textiles and rubber samples. They can be used along with TMA cutting presses for the preparation of samples.

They can be used for the following Applications:

- Cardboard
- Foam
- Paper
- Plastic
- Rubber

Key Features:

- Able to be resharpened
- Longer service life than other dies

Standards:

- BS 2782-3
- AS 1683.11
- AS 2282.7
- ASTM D470
- ASTM D1004
- ASTM D1822
- ASTM D638
- ISO 34-1
- ISO 527
- ISO 6259
- K6301
- ASTM D882
- AS 1301.404
- AS 1180.2
- ASTM D412
- ASTM D624
- ASTM 1660.2
- ASTM D3574
- AS 1145
- ISO 37
- ISO 1798
- K6251
- AS/NZS 1660.2.3

Options:

- Custom Dies - available on request
- Cutting Die Adaptors
- Cutting Press
- Certification



Dimensions:

- Refer diagrams below
- All dimensions in mm

TMA-CD174 – Type A

- ISO 37-Type 2
- ISO 527-2-Type 5A
- AS 1145-Type 5A
- K6251-Type 6
- AS/NZS 1660.2.3
- DIN53504

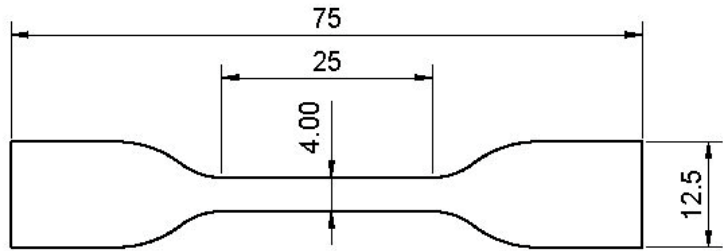

TMA-CD174 – Type B

- ASTM D412-C
- ISO 6259-3-Type 2
- K6251-Type 5
- ISO 37 – Type 1
- ISO 37-1 Type 2
- ISO 527-3 – Type 5
- BS 2782-3 (Method 320A)
- AS 1145.3 – Type 5
- DIN53504
- ASTM D882

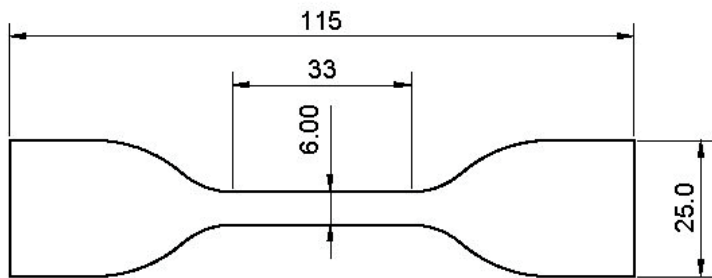

TMA-CD174 – Type C

- ASTM D412-D

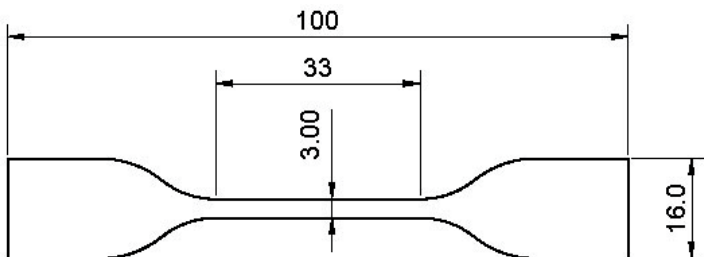

TMA-CD174 – Type D

- JIS K6301-Type 3
- K6251- Type 3
- ISO 37 – Type 1A

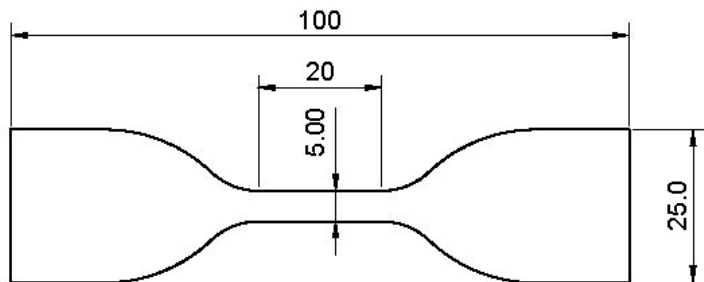

TMA-CD174 – Type E

- ASTM D638-02a-Type 4
- ASTM D6693

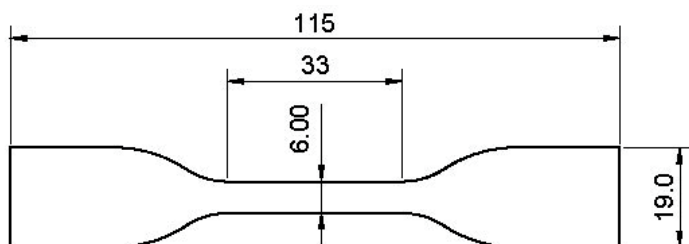

Dimensions:

- Refer diagrams below
- All dimensions in mm

TMA-CD174 – Type F

- JIS K6301-Type 1

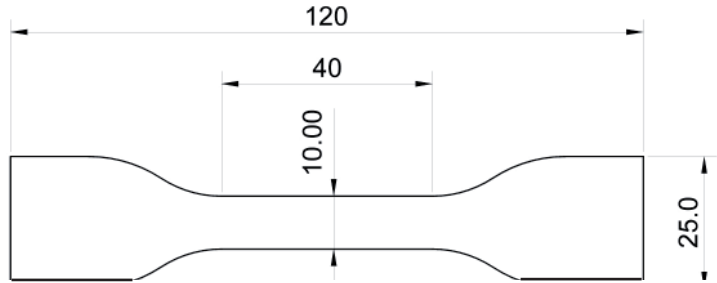

TMA-CD174 – Type G

- JIS K6301-Type 2

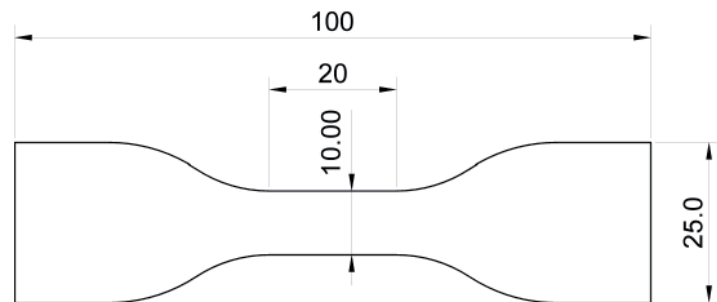

TMA-CD174 – Type H

- JIS K6301-Type 4

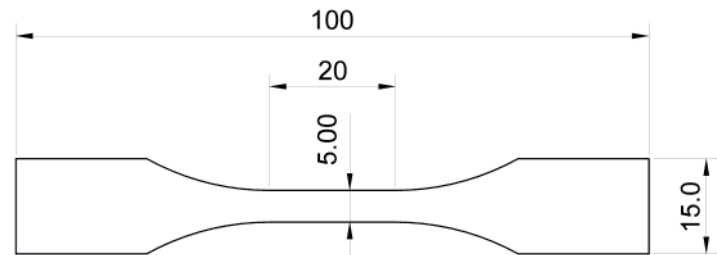

TMA-CD174 – Type I

- ISO 37 -Type 3
- AS/NZS 1660.2.3
- DIN 53504

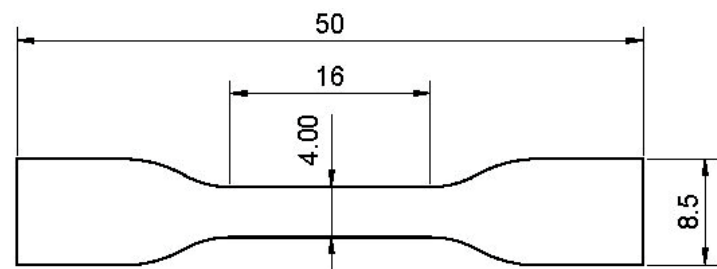

TMA-CD174 – Type J

- ISO 37 - Type 4
- ISO 527-2 - tYPE 5B

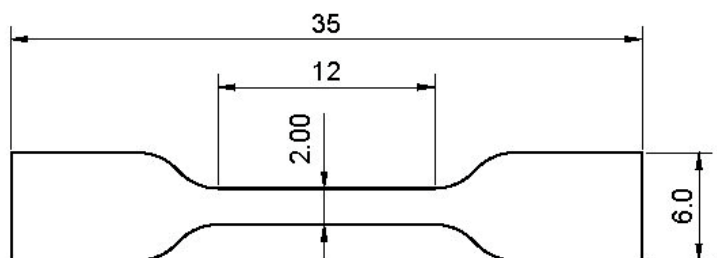

Dimensions:

- Refer diagrams below
- All dimensions in mm

TMA-CD174 – Type K

- K6301 - B
- ASTM D624 -Type C
- ASTM D1004-3
- DIN ISO34-1

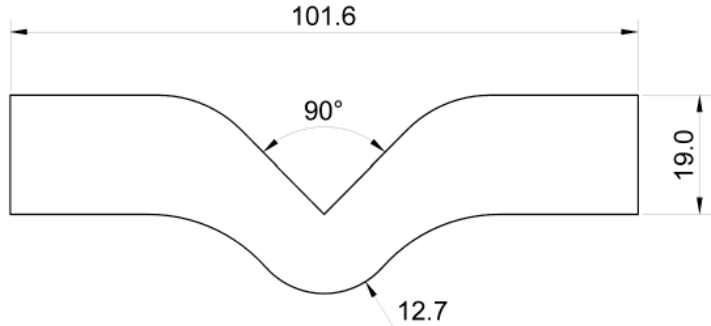

TMA-CD174 – Type L

- ASTM D638-02a - Type 1

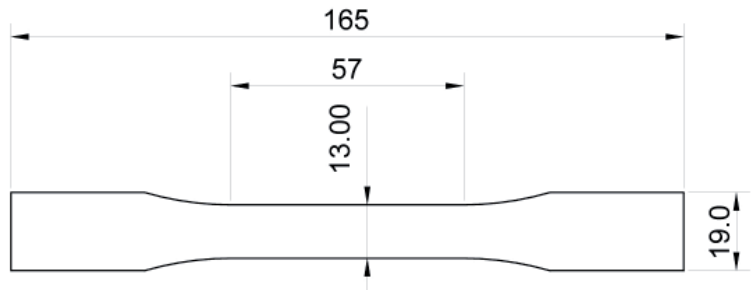

TMA-CD174 – Type M

- ASTM D638-02a - Type 2

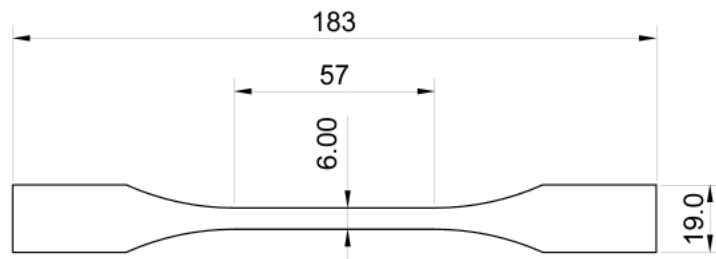

TMA-CD174 – Type N

- ASTM D638-02a - Type 3

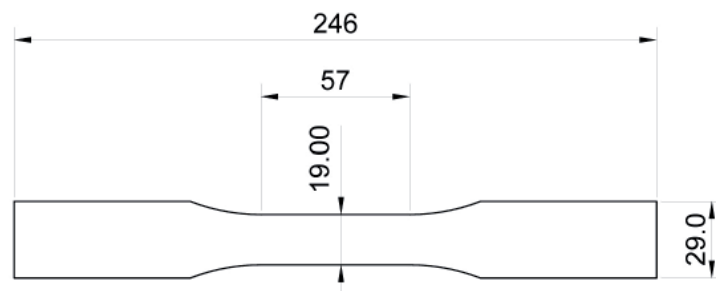

TMA-CD174 – Type O

- ASTM D638-02a - Type 5

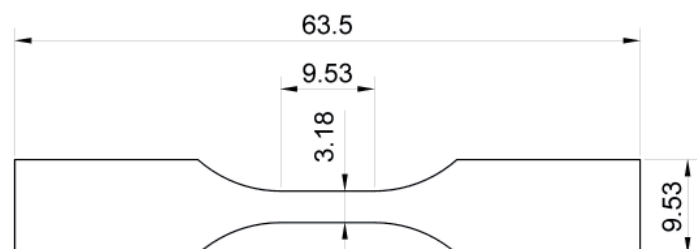

Dimensions:

- Refer diagrams below
- All dimensions in mm

TMA-CD174 – Type P

- DIN ISO 34-1
- K6301-Type A
- ASTM D624 - Type B

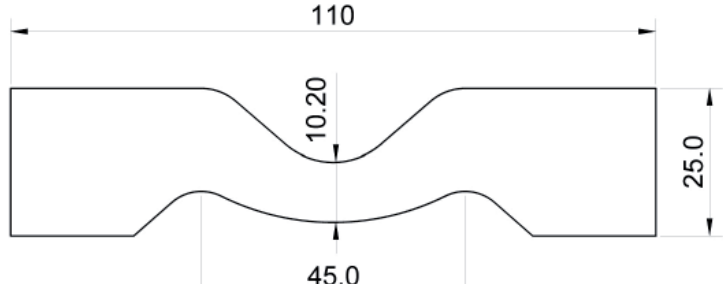

TMA-CD174 – Type Q

- ASTM D1822 - Type L

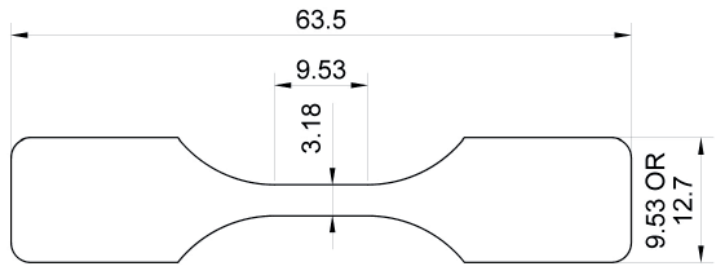

TMA-CD174 – Type R

- ASTM D1822 - Type S

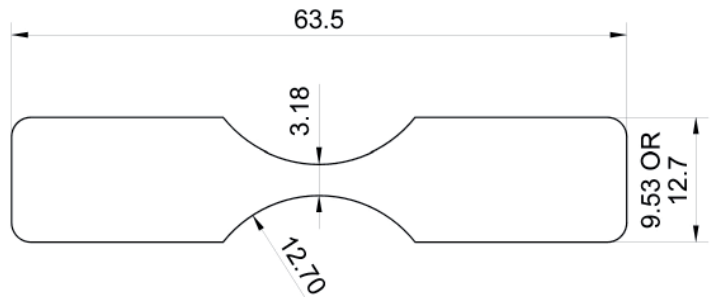

TMA-CD174 – Type S

- ASTM D3574 - Type E

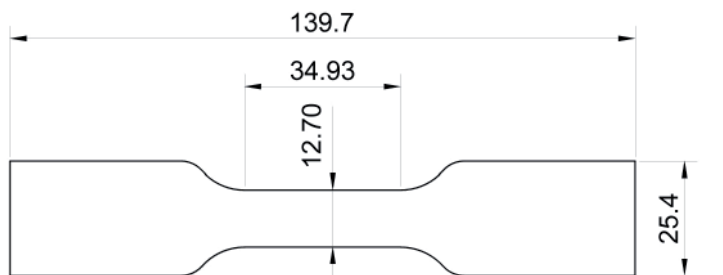

TMA-CD174 – Type T

- ASTM D3574 - Type F
- DIN ISO34-1

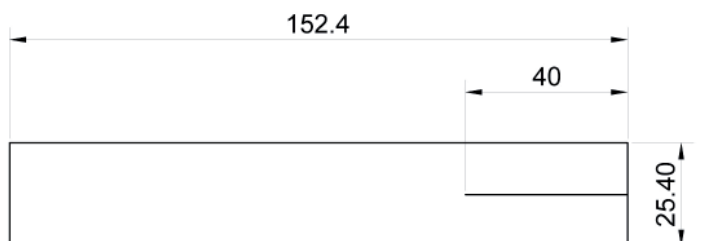

Dimensions:

- Refer diagrams below
- All dimensions in mm

TMA-CD174 – Type U

- ISO 527-2 - Type 1A

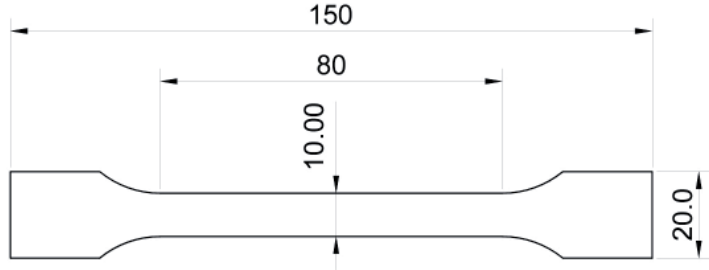

TMA-CD174 – Type V

- ISO 527-2 - Type 1B
- ISO 527-3 - Type 1B
- BS 2782-3 (Method 320B)
- BS 2782-10 - Type 1
- ISO 6259-3 - Type 1

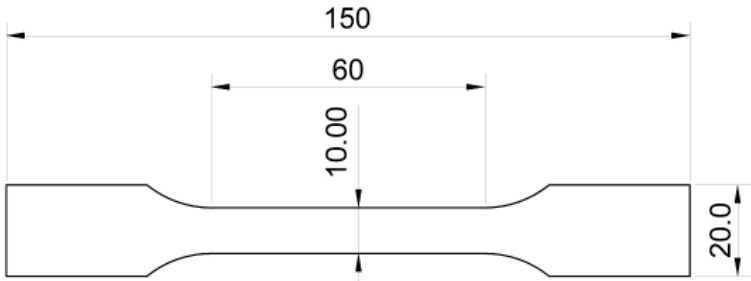

TMA-CD174 – Type W

- ISO 527-2 - Type 1BA

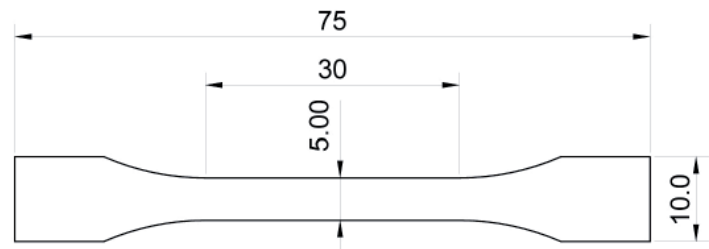

TMA-CD174 – Type X

- ISO 572-2 - Type 1BB

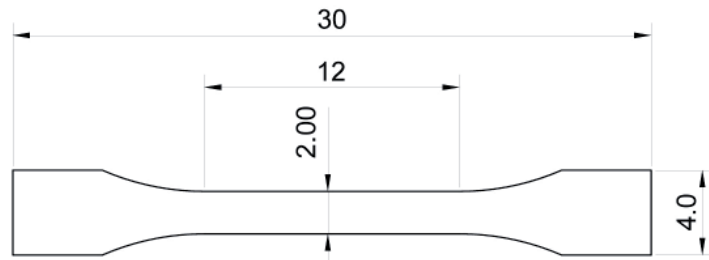

TMA-CD174 – Type Y

- ISO 527-3 - Type 2
- AS 1145.2 - Type 2



Dimensions:

- Refer diagrams below
- All dimensions in mm

TMA-CD174 – Type Z

- ISO 527-33 - Type 4

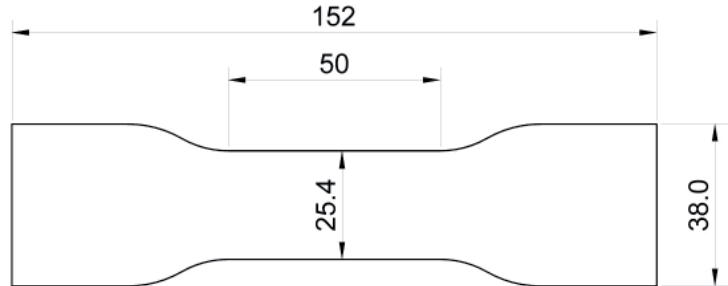

TMA-CD174 – Type Aa

- ASTM D412 - Type A

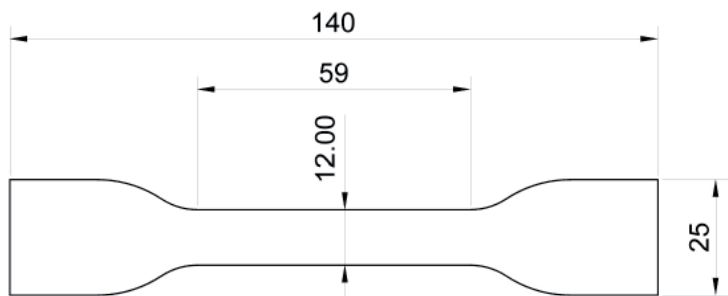

TMA-CD174 – Type Ab

- ASTM D412 - Type B

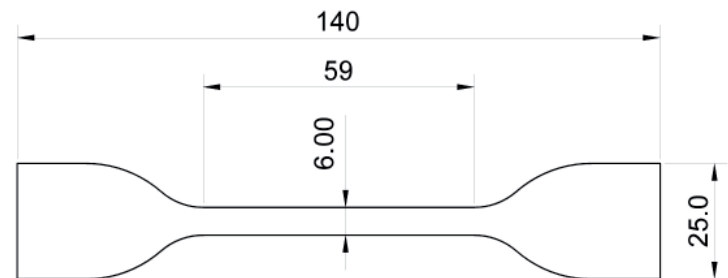

TMA-CD174 – Type Ac

- ASTM D412 - Type E

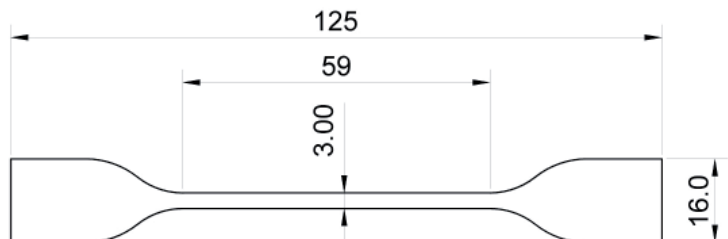

TMA-CD174 – Type Ad

- ASTM D412 - Type F

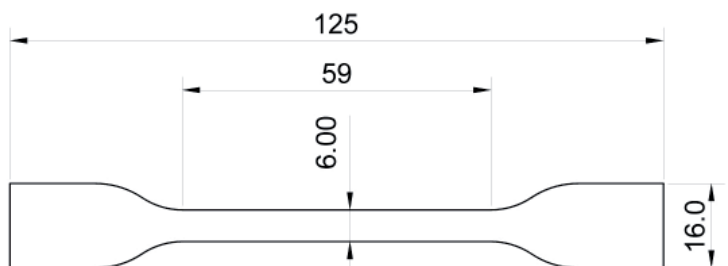

Dimensions:

- Refer diagrams below
- All dimensions in mm

TMA-CD174 – Type Ae

- ISO 1798

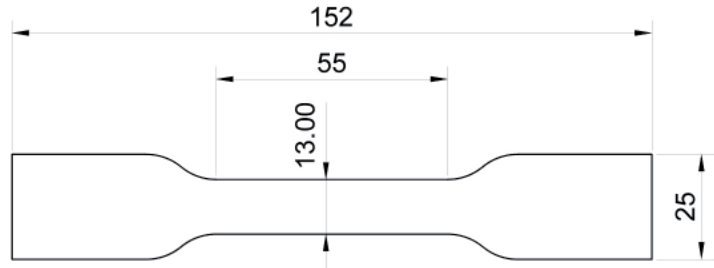

TMA-CD174 – Type Af

- ASTM D1708
- ASTM D2116
- ASTM D4894
- ASTM D4895
- JIS K7137-2-A
- JIS K6935-2

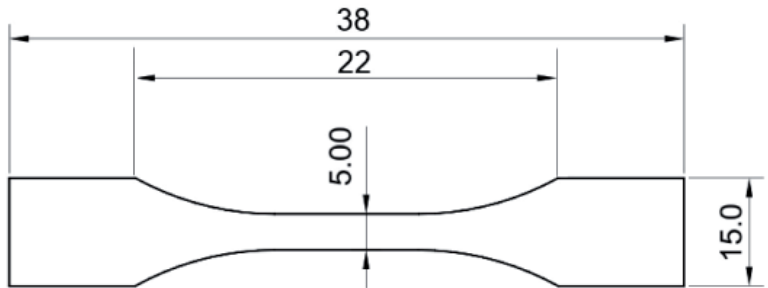

* Other custom dies are available upon request.